







14 Rempstone Road

Swanage, BH19 1DS

 3  2  2  C

Share of Freehold

Hull
Gregson
Hull



14 Rempstone Road

Swanage, BH19 1DS

- Superbly Located Ground Floor Apartment
- Close to Main Beach and All Town Centre Amenities
- Three Bedrooms (One with En-Suite)
- Spacious Reception Room
- Unique Development in Art Deco Style
- Good Sized Kitchen
- Allocated Parking Space
- Paved Front Garden and Patio to Rear
- Share of the Freehold
- No Forward Chain





CONVENIENTLY LOCATED in the heart of Swanage and just a SHORT DISTANCE FROM THE SEAFRONT and town centre amenities this GROUND FLOOR APARTMENT has THREE BEDROOMS and the benefit of an ALLOCATED PARKING SPACE.



'Deco' is an elegant, modern development of 7 apartments constructed in 1930's art deco style which overlooks open recreation ground with Swanage Beach just a stone's throw beyond.

Enter through the smart communal entrance lobby and



into a spacious and bright hallway through to the main reception room. Here floor to ceiling windows and French doors present an outlook over Horsecliffe Lane towards the open recreation ground with its popular bandstand and the War Memorial. This spacious room provides an ideal place to dine and to enjoy the scene in the Summer months and the sunrise throughout the year. Step outside and a patio provides a place to site a small table and chairs.

The Kitchen also has an easterly outlook over the recreation ground and provides ample room for food preparation and a good array of storage cupboards. It includes an integral, eye-level double oven, six burner gas hob with filtration hood, dishwasher and space to site a fridge/freezer and washing machine.

Return to the hallway to find the spacious, 18' long Main Bedroom which has feature, art deco inspired curved walls and a bright westerly aspect. An en suite shower room comprises walk in shower cubicle with glazed screen, pedestal basin and WC. Adjacent, Bedroom Two which has a private exit to the front of the building onto a private paved and westerly facing garden, ideal for taking advantage of the afternoon sun.

Bedroom Three is an ideal guest room or could be used as a study, office or workroom. The Bathroom has half-tiled walls with a white suite comprising oval bath with shower attachment, washbasin and WC.

The apartment includes an allocated parking space which is situated close to the rear of the property and accessed from Horsecliffe Lane.



Rempstone Road, Swanage, BH19

Approximate Area = 974 sq ft / 90.5 sq m
For identification only - Not to scale

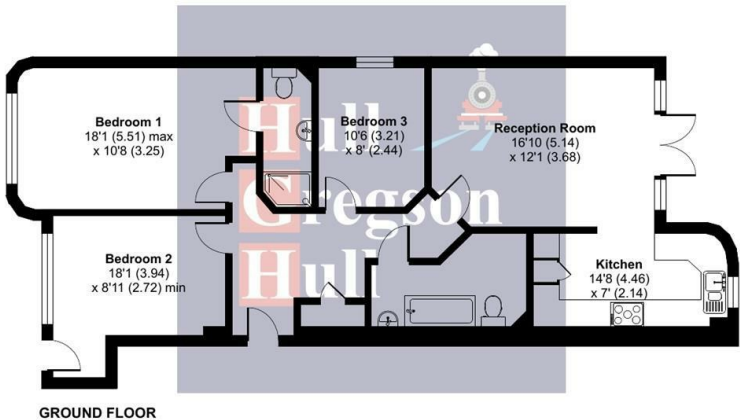

Lounge/Dining Room 16'10" x 12'0" (5.14 x 3.68)

Kitchen 14'7" x 7'0" (4.46 x 2.14)

Bedroom One 18'0" 10'7" (5.51 3.25)

Bedroom Two 12'11" x 8'11" (3.94 x 2.72)

Bedroom Three/Study 10'6" x 8'0" (3.21 x 2.44)

Bathroom

Additional Information.

The following details have been provided by the vendor, as required by Trading Standards. These details should be checked by your legal representative for accuracy.

Property type: Ground Floor Apartment

Property construction: Standard

Tenure: Leasehold Share of Freehold. Lease of 125 years from 2003. Maintenance charge is £2430 per annum.

Long lets and holiday lets are permitted and pets at the discretion of the Management (these details should be confirmed with your Solicitor).

Mains Electricity

Mains Water & Sewage: Supplied by Wessex Water

Heating Type: Gas central heating.

Broadband/Mobile signal/coverage: For further details please see the Ofcom Mobile Signal & Broadband checker. checker.ofcom.org.uk/

Disclaimer.

These particulars, whilst believed to be accurate are set out as a general outline only for guidance and do not constitute any part of an offer or contract. Intending purchasers should not rely on them as statements of representation of fact but must satisfy themselves by inspection or otherwise as to their accuracy. All measurements are approximate. Any details including (but not limited to): lease details, service charges, ground rents, property construction, services, & covenant information are provided by the vendor, and you should consult with your legal advisor/ satisfy yourself before proceeding. No person in this firm's employment has the authority to make or give any representation or warranty in respect of the property.

Floor plan produced in accordance with RICS Property Measurement Standards incorporating International Property Measurement Standards (IPMS2 Residential). © nchecom 2024. Produced for Hull Gregson & Hull (Swanage) Ltd. REF: 1247722

